

Superreel® - Industrial Reel

ASSH280S SERIES



FEATURES

- Single pedestal, lightweight design. Heavy gauge steel stampings
- Reel drive springs manufactured from high-quality, scaleless blue tempered steel.
- Anti-lockout design: Ratchet prevents lockup when hose is fully extended, eliminating the need to manually release the pawl at the reel.
- Superior performance: Swivel and reel ball bearings reduce torque load on power spring for smooth retraction and durability.
- Corrosion resistant: Sealed bearings prevent contamination and minimize maintenance.
- Easy installation and maintenance: Factory lubricated one-piece power spring cassette make installation safer and maintenance easier.
- Adjustable and Versatile: Guide arm adjust to wall, floor, vehicle, overhead positions. Narrow design allows for maximum use of available space.



Superreel® - Industrial Reel

DIMENSIONS

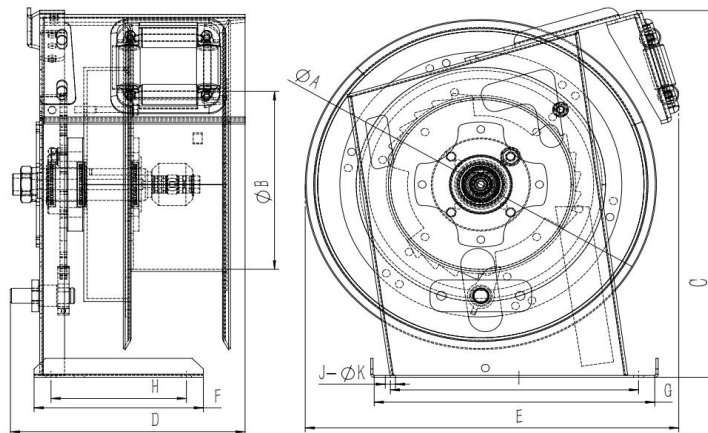

P/N	Port&core number	HOSE-ID. or CABLE-square	Pressure or I _{max}	Working Length	Reel inlet	Hose outlet	A	B	C	D	E	F	G	H	I	J	K
ASSH280S0101016010	1	1/4"	1.6Mpa	10m	BSPT1/4".F	BSPT1/4".M	290	165	379	206	300	150	260	120	220	4	9
ASSH280S0102016010	1	5/16"	1.6Mpa	9m	BSPT3/8".F	BSPT3/8".M	290	165	379	206	300	150	260	120	220	4	9
ASSH280S0103016010	1	3/8"	1.6Mpa	8m	BSPT3/8".F	BSPT3/8".M	290	165	379	206	300	150	260	120	220	4	9
ASSH280S0104016010	1	3/8"	1.6Mpa	6m	BSPT3/8".F	BSPT1/2".M	290	165	379	206	300	150	260	120	220	4	9
							Dimensions are in millimeter										

